

DYNAMIS

LEAD-LINE 20-6 G5

Rechargeable Sealed Lead-Acid Battery



Specification

Nominal Voltage (V) 6V

Nominal Capacity

20 hour rate (1A to 5,25V)	20Ah
10 hour rate (2A to 5,25V)	20Ah
5 hour rate (3,4A to 5,25V)	17Ah
1C (20A to 4,80V)	9Ah
3C (60A to 4,80V)	7,2Ah

Weight 3,993 kg

Internal Resistance (at 1kHz) 5 mΩ

Maximum Discharge Current for 30 seconds: 400A

Maximum Discharge Current for 5 seconds: 800A

Operating Temperature Range

Charge	0°C to 40°C
Discharge	-15°C to 50°C
Storage	-15°C to 40°C

Charge Retention (shelf life) at 20°C

1 month	92%
3 month	90%
6 month	80%

Charging Methods at 25°C

Cycle use:

Charging Voltage 7,20 to 7,50V
Maximum Charging Current: 6A

Standby use:

Float Charging Voltage 6,75 to 6,90V

Life expectancy:

Cycle Use:

100% depth of discharge 200 cycles
80% depth of discharge 225 cycles
50% depth of discharge 500 cycles

Standby Use: 3 ~ 5 years

Case Material: ABS

(Option: 94-HB & 94V-0 flame retardant case)

Terminal Type: G5

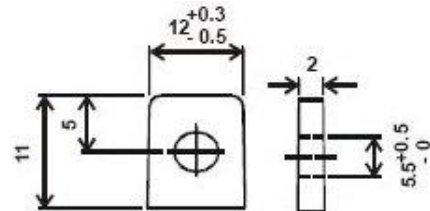

G-Pole

Order no. 60.05008

Certified according to UL.

